



AICHI UNIVERSITY OF EDUCATION

International House

Objective

The International House has been designed to provide accommodation for international students and researchers and a place for events pertaining to international fellowship, and to promote international exchanges and understanding.

Address

1 Hirosawa, Igaya-cho, Kariya-shi, Aichi 448-8542, Japan



Section responsible for International House

Center for International Exchange is responsible for the administration of the International House.

Office hours are as follows: Monday to Friday: 9:00 to 12:00, 13:00 to 16:00

The office is closed on Saturdays, Sundays, University's holidays and National Holidays including the New Year Holidays (December 29 to January 3).

Phone: 0566-26-2178

Mail: kokusaikoryu@m.auecc.aichi-edu.a.cjp

Residence in the International House is limited to the following persons:

- 1) International students studying at the University and their spouses and children.
- 2) International researchers engaged in research at the University and their spouses and children.
(However, those who are employed under contract in accordance with University Corporation Aichi University of Education Rule of Employment Article 5, Paragraph 3 are excluded.)
- 3) Other persons approved by the President

The period of residence

The normal period of residence is within one year. However, research students are allowed only 6 months, regardless of period of stay.

If there are vacancies after expiration of a period of residence at International House, you are able to apply for International House again. The period of stay is not exceeding 1 year.

In this case, residents need to submit "Application for Extension of Residence in the International House to the Center for International Exchange at least 1 month before expiration of limitation period. A person granted permission of residence will be issued "Permit for Residence Extension at the International House"

Rent for International students

Rent must be paid according to the stipulations of the Rules and Regulations of Aichi University of Education as indicated below.

Type of Room	Rent (per month)
Single room	JPY 4,700
Couple room	JPY 11,900
Family room	JPY 14,200

Utilities and other Expenses

Type of Room	① Private Utility	② Public Utility	③ Communal Expenses	④ Internet Rent	⑤ Individual Room Cleaning fee
Single room (Student)	Calculated according to the amount used by the resident.	<u><Single room residents></u> ¥6,000/month (charged every month) Electricity ¥ 1,800 Water ¥ 2,600 Gas ¥ 1,600 <u><Couple/Family room residents></u> Calculated according to the actual amount used by the resident.	¥1,800/month (charged every month)	¥1,500/month (charged every month)	¥15,000
Couple room					¥28,000
Family room					¥28,000

Outline of International

The International House has been designed to provide accommodation for international students and researchers and a place for events pertaining to international fellowship, and to promote international exchanges and understanding. The International House consists of two reinforced concrete buildings with the total floor area of 1,000 m² : the single room building (tree- stories) and the couple room and family room building (three- stories)

	Total Room name		Numbers of room	area(m ²)
Building for single	International students	Single room	21	14
	International researchers	Single room	3	18
	Total		24	32
Building for couples and families	International students	Couple room	1	40
		Family room	1	55
	International researchers	Couple room	2	40
		Family room	2	55
	Total		6	190

Management facilities	Room name	Numbers of room	area(m ²)
	Office room	1	13
	Trunk room	1	16
	Entrance hall	1	24
	hot water supply room.	1	6
	Store room	2	Total 10

facility for common use	Room name	Numbers of rooms	area(m ²)
	Multi-purpose hall	1	52
	Shower Dressing room	3	4
	Laundry	3	3
	1F washroom	2	6

Internet Environment	outlet of wired LAN
----------------------	---------------------

○ Building for single *Mainly for Exchange Students

Equipment in the room

desk/chair/bookshelf/Bed/closet/mini kitchen/mini fridge/microwave/air conditioner/curtain/
bedding sets (AUE Center for International Exchange will prepare the set including futon, futon cover, quilt, quilt cover and pillow, pillow case. Please pay about JPY 8,000 after arrival.)

Items to prepare by your own

Daily necessities (plates and utensils, toilet paper, towel, shampoo, hair conditioner, soap, toothpaste, slippers, pajamas etc.)/Internet Lan cable or Wi-fi Router

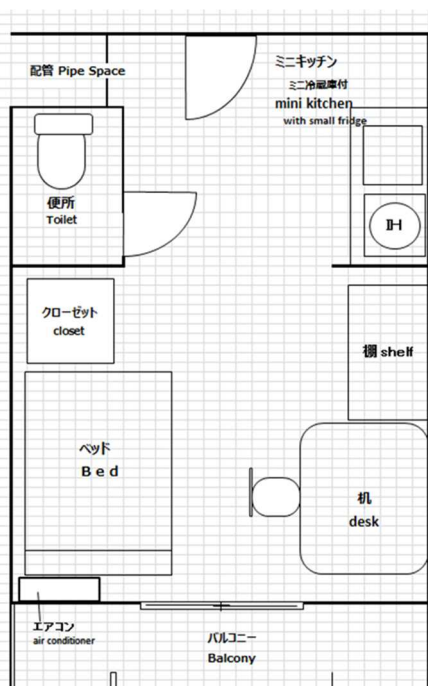

Shared Dressing room (Washing Machine/ shower)

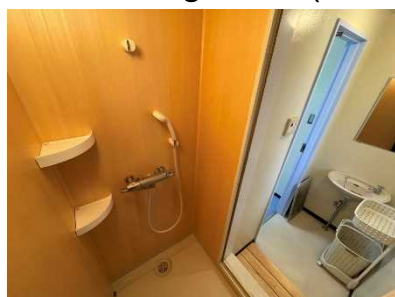

○ Building for families

国際交流会館居室見取図 夫婦家族棟（家族）

Layout of an International House Family Room

洋室55㎡（設備部分含） Western Room



Equipment in the room

Desk & chairs,
Bookshelf
bed
locker
kitchen
cupboard
refrigerator
electric kettle
dining table and chairs,
microwave
washing machine
vacuum
sofa
air conditioner
curtains
shoe cabinet

Items to prepare by your own

plates and utensils,
toilet paper
towel,
shampoo & hair conditioner,
soap
toothpaste
slippers
pajamas
Lan cable or Wi-fi router etc.

International House

Shared space and the single room building



the couple room and family room building



* Entrance hall



* Trunk room



* Office room (No permanent staff is working here)



* Hot Water Supply Room (Fridge, Kitchen sink, Microwave for party only)



* Multi-purpose hall for meeting or party (Sofa, desk, piano, TV, table tennis table, printer etc.)



Parking place for shared bicycles



Garbage station

